

**ROBERT NOBLE ARCHITECT A.I.A.**  
 119 SOUTH BROAD ST.  
 ROME, GA 30161  
 PH: (706) 295-2700  
 FX: (706) 295-2063  
 Website: RNArchitect.net

**NOT FOR CONSTRUCTION**

**FLOYD COUNTY PUBLIC WORKS  
 ROME-FLOYD RECYCLING CENTER**  
 LAVENDER DRIVE  
 Rome, Georgia 30165

**NOT FOR CONSTRUCTION**

1st FLOOR PLAN

PROJECT # 1715  
 DESIGNER/CAD TECH:  
**L. A. (Tony) LOMBARD**  
 DATE: ##/##/####  
 REV. DATE:

**A1.1**

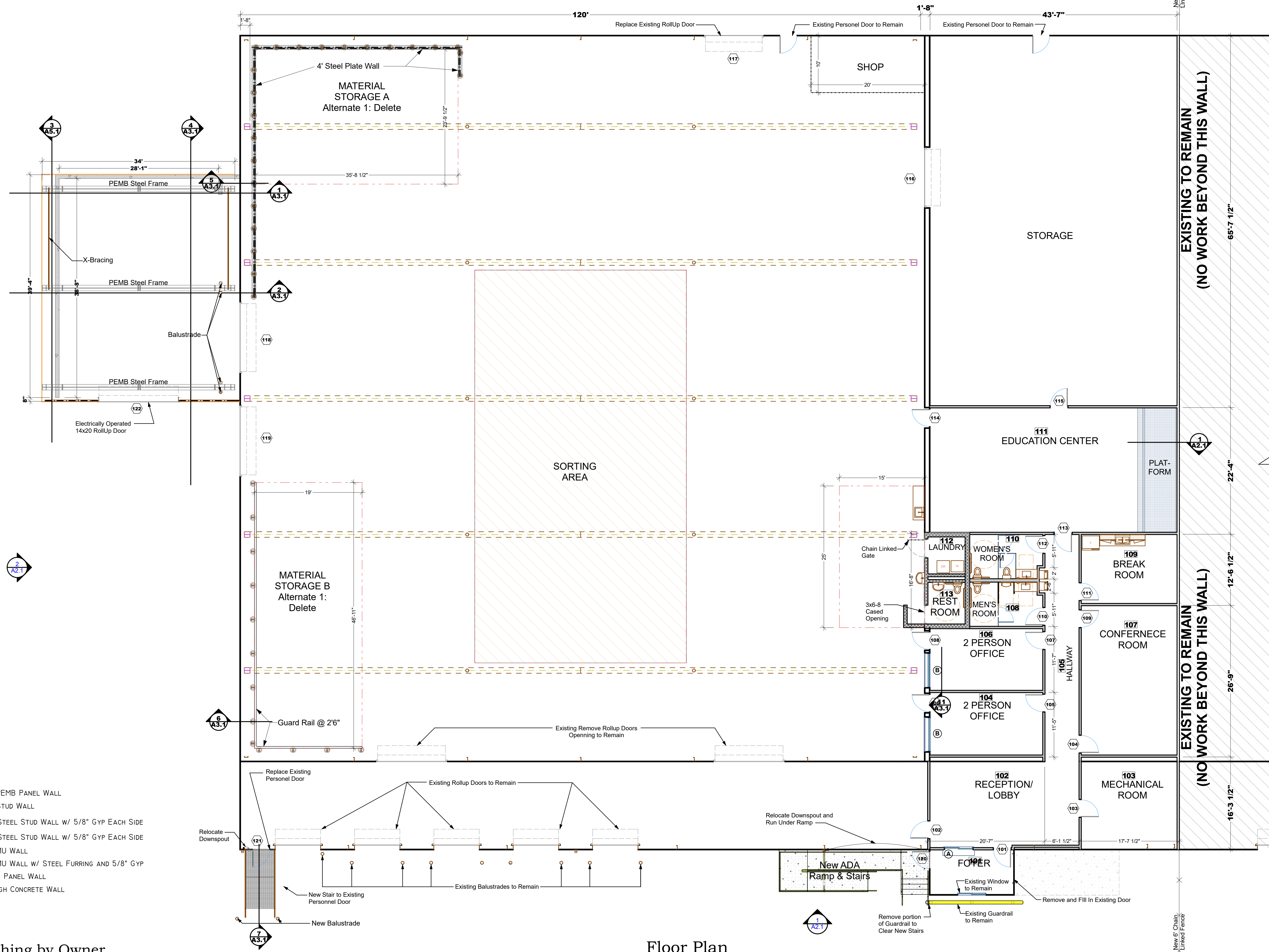

- WALL LEGEND**
- EXISTING PEMB PANEL WALL
  - EXISTING STUD WALL
  - NEW 2X4 STEEL STUD WALL W/ 5/8" GYP EACH SIDE
  - NEW 2X6 STEEL STUD WALL W/ 5/8" GYP EACH SIDE
  - NEW 8" CMU WALL
  - NEW 8" CMU WALL W/ STEEL FURRING AND 5/8" GYP
  - NEW PEMB PANEL WALL
  - NEW 4" HIGH CONCRETE WALL

**NOTE:**  
 All Trenching by Owner

**Floor Plan**  
 Scale: 1/8" = 1'